



**SEVATTO PHARMA**

ADORNING YOUR HEALTH BETTER

**Factory: Survey No.494, Village: Bamanva  
(Dharmaj - Khambhat Road)  
Tal : Khambhat, Dist. : Anand,  
Pin: 388580**

**Office: 303 NEWYORK PLAZA, BODAKDEV  
AHMEDABAD-380015,GUJARAT,INDIA**

**PLANT PRODUCTION CAPACITY**  
**SMALL VOLUME PARENTIAL SECTION**

---

We are having five lines namely:

❖ **AMPOULE MANUFACTURING LINE**

**Capacity** : 1ml to 25ml, 80,000 Amp/Shift

❖ **VIAL MANUFACTURING LINE**

**Capacity** : 10ml to 100ml, 60,000 Vials/Shift

❖ **LYOPHILIZED VIALS LINE**

**Capacity** : 0.3ml to 10ml, 20,000 Vials/Shift

- Alternatively, Propofol vials of 40000 vials

## **BETA-LACTAM SECTION**

### **❖ VIAL POWDER INJECTIONS**

**Capacity** : 250mg to 1000mg, 60,000 Vials/Shift

### **❖ OIL BASED POWDER LINE**

**Capacity** : 5ml to 10ml, 20,000 Vials/Shift

## CERTIFICATIONS AND STANDARDS

---

- ❖ The plant is set up considering **WHO-GMP** Standards and **PIC/S** Standards.
- ❖ All lines are dedicated lines with Rotary Washing, Dehydrogenation Tunnel, complete Filling and Sealing Lines, Sterilizing facilities wherever required , Automatic Sticker Labelling and Online Packing Arrangements

- ❖ The unit is having full fledged Quality Control Laboratory as per GLP norms having separate Microbiology, Chemical Section, Stability Section and relevant developing facilities with all Modern Instruments including HPLC.
- ❖ Separate QA arrangements with qualified Staff headed by M Pharm PHD person.

- ❖ Site is in pollution free area with about 215000 sq. ft. area having about 150000 sq. ft. constructed area.
- ❖ The facility includes 1600 KW power line, centrally Air-Conditioned with two Chillers, a Boiler and separate Nitrogen Plant.
- ❖ Plant is having all the modern facilities including Internal Communication Centers, CCTV, Automatic Door Locking System facilities with operation of only Authorized persons, Proper Water Harvesting Systems, Separate ETP & STP Plants and Fire Fighting system with smoke detection facilities



# BUILDING











# AMPOULE WASHING & TUNNELING



# AMPOULE FILLING



# VIAL WASHING & TUNNELING





# VIAL FILLING



# SMALL VOLUME PARENTERAL PLANT

## LABOARATORY PLAN

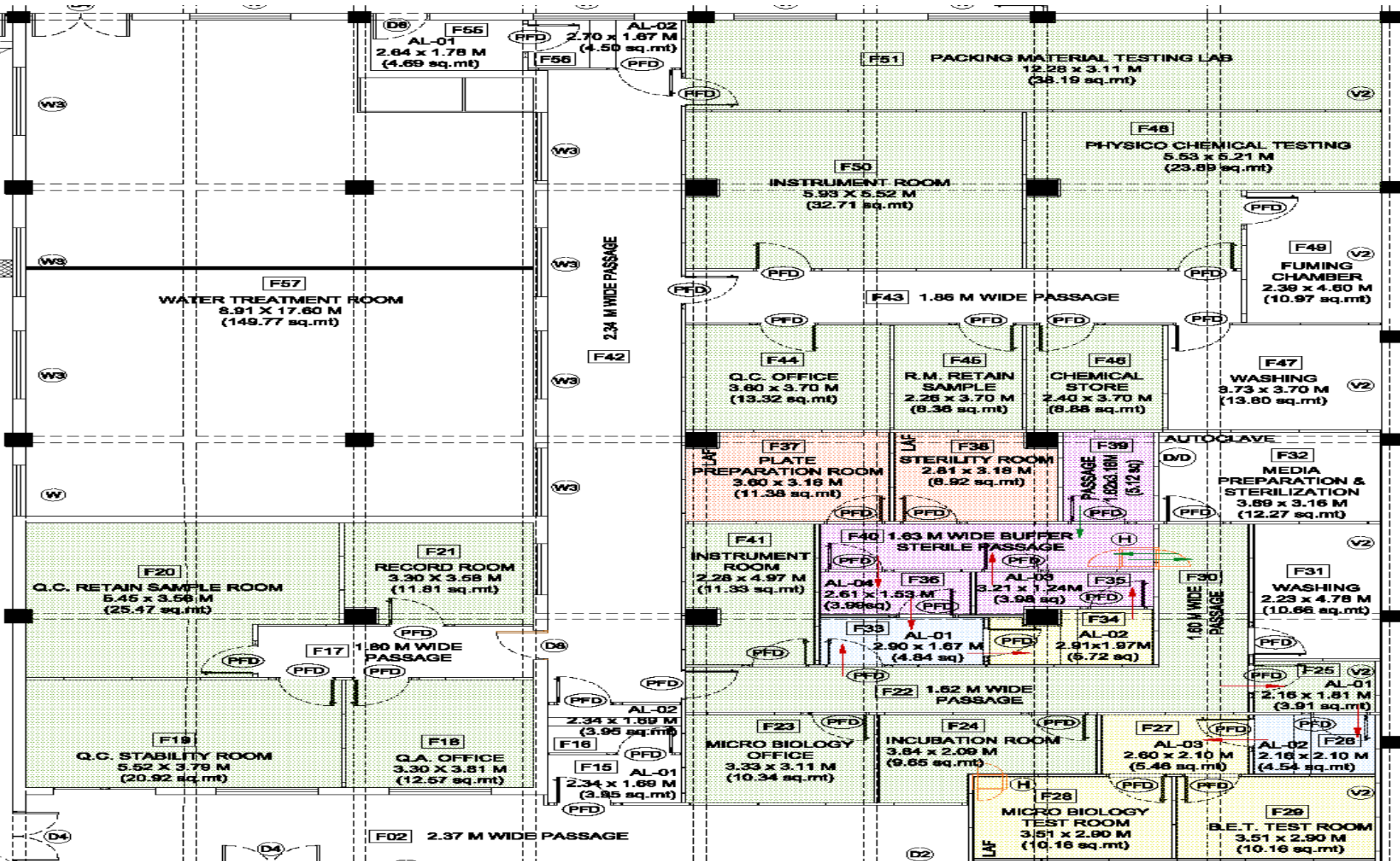



# TOC INSTRUMENT- LABORATORY





# LIQUID PARTICLE COUNTER-LABORATORY



# BETA - LACTAM

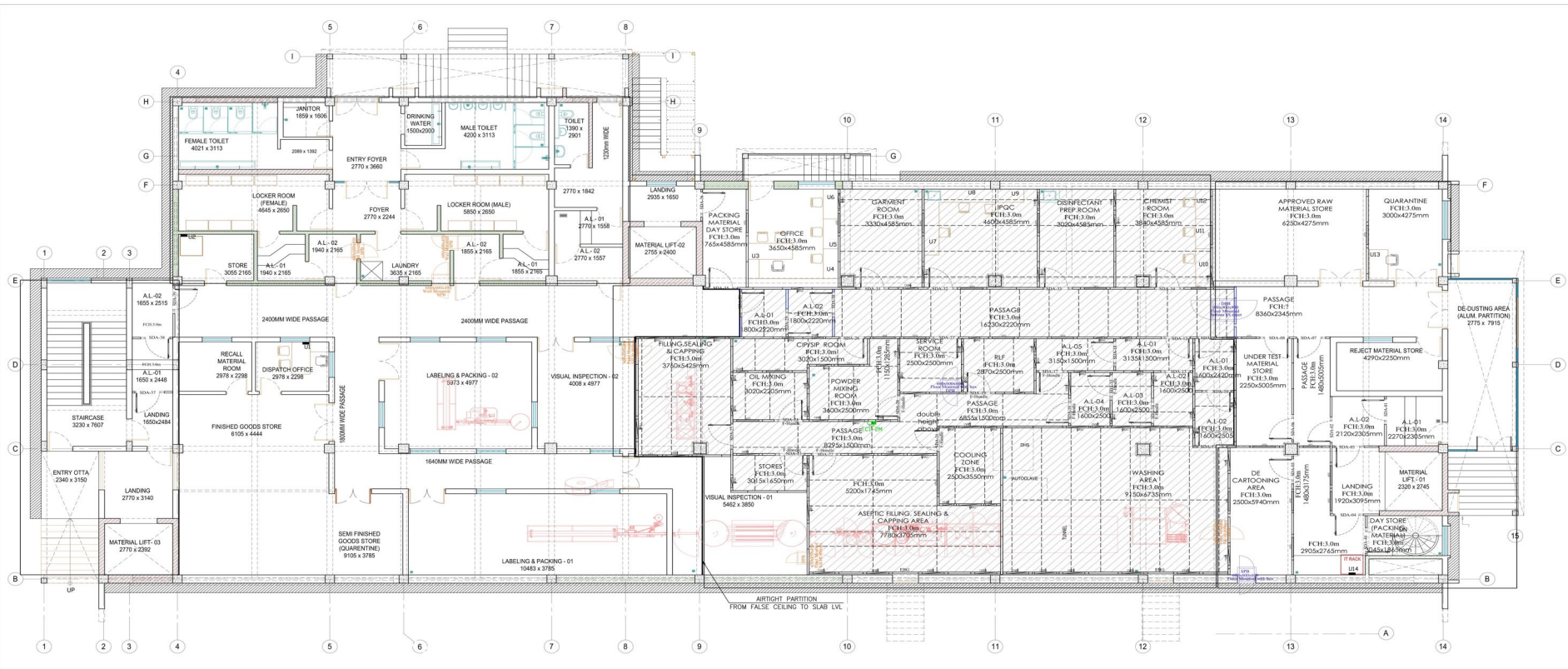



# BETA LACTAM BUILDING



# BETA-LACTAM WASHING





# BETA-LACTAM FILLING

---



# LYOPHILIZER MACHINE



# WATER SYSTEM- UTILITY





# UTILITY BUILDING





## SPECIAL PRODUCT

WE HAVE APPLIED FOR REMDESIVIR INJECTION  
AND PERMISSION IS AVAITED AT ANY TIME

### ❖ LIQUID INJECTABLES RANGE

---

- ❖ HEPARIN 5000 I.U
- ❖ HEPARIN 25000 I TERLIPRESSIN INJ
- ❖ CLINDAMYCIN 300 MG / 2 ML
- ❖ CLINDAMYCIN 600 MG / 4 ML

## LIQUID INJECTABLES RANGE

---

- ❖ GENTAMICIN INJ 80 MG / 2 ML
- ❖ DEXAMETHAZONE INJ 4 MG / 2 ML
- ❖ TREMADOL AMPONLES 50 MG / 2 ML
- ❖ OXYTETRACYCLINE INJ 50 MG / 2 ML
- ❖ ONDENSETRON INJ 4 MG / 2 ML
- ❖ ATROPINE SULPHATE INJ. I.P. 0.6MG/ML 1ML
- ❖ ADRENALINE TARTRATE INJECTION 1ML
- ❖ AMIKACIN SULPHATE INJ. I.P. 2ML VIAL
- ❖ ARTEETHER INJ. 2ML
- ❖ CALCIUM GLUCONATE INJ. 10ML
- ❖ INJECTION OF CALCIUM GLUCONO-GALACTO- GLUCONATE EQUIVALENT TO 10% CALCIUM GLUCONATE 10ML

## LIQUID INJECTABLES RANGE

---

- ❖ DEXTROSE INJECTION I.P. 25% W/V.25ML
- ❖ DEXTROSE INJECTION I.P. 50% W/V 25ML
- ❖ DICLOFENAC SODIUM INJ. I.P. 25MG/ML 3ML
- ❖ EPHEDRINE HCL INJ. I.P 30MG 1ML
- ❖ PAM INJ. 500MG /ML 20ML (BLISTER PACK) 20ML
- ❖ ETOFYLLINE & THEOPHYLLINE INJ. 2ML
- ❖ ADRENOCROME MONO-SEMI CARBAZONE INJ. 2ML
- ❖ EPHEDRINE HCL INJ. I.P 30MG 1ML
- ❖ WATER FOR INJECTION I.P. 50ML

## LIQUID INJECTABLES RANGE

---

- ❖ PAM INJ. 500MG /ML 20ML (BLISTER PACK) 20ML
- ❖ ETOFYLLINE & THEOPHYLLINE INJ. 2ML
- ❖ ADRENOCHROME MONO SEMI CARBAZONE INJ. 2ML
- ❖ LINCOMYCIN INJ. 2ML
- ❖ POTASSIUM CHLORIDE CONCENTRATE STERILE B.P.  
15% W/V 10ML
- ❖ PAPAVERINE HCL U.S.P. 2ML (2ML X 10 TRAY)
- ❖ PARACITAM INJ. 15ML AMP
- ❖ SODIUM CHLORIDE INJECTION. I.P. 0.9% W/V 10ML

## LIQUID INJECTABLES RANGE

---

- ❖ SODIUM CHLORIDE INJECTION. I.P. 0.9% W/V 25ML
- ❖ SODIUM BICARBONATE INJECTION B.P. 7.5% W/V 10ML
- ❖ SODIUM BICARBONATE INJECTION.B.P. 7.5% W/V 25ML
- ❖ STERILE WATER FOR INJECTION I.P. 5ML
- ❖ STERILE WATER FOR INJECTION I.P. 10ML
- ❖ MAG.SULPHATE INJ. B.P. 25% W/V 2ML
- ❖ MAGNESIUM SULPHATE INJECTION B.P. 50% W/V 2ML
- ❖ MANAPH.SODI.BISU.INJ.10MG/ML 1ML

## LIQUID INJECTABLES RANGE

---

- ❖ TRAMADOL HCL INJ. 50MG/ML 1ML
- ❖ TRAMADOL HCL INJ. 50MG/ML 2ML
- ❖ OXYTOCIN INJ. I.P 5 I.U/ML 1ML [SINGLE BLISTER PACK]
- ❖ ETHASYLATE INJ.125MG/ML 2ML
- ❖ ONDANSETRON INJ. U.S.P. 2ML
- ❖ GLYCOPYRROLATE INJ. U.S.P. 1ML
- ❖ RANITIDINE HCL INJ. I.P. 25MG/ML. 2ML
- ❖ VITAMIN-C (ASCORBIC ACID INJ. I.P.100MG/ML) 5ML
- ❖ WATER FOR INJECTION I.P. 50ML

## PENICILLINS GROUPS

- ❖ AMPICILLIN 250 MG CLOXACILLIN 250 MG
- ❖ AMPICILLIN 500 MG CLOXACILLIN 250 MG
- ❖ AMOXYCILLIN 1 GM CLAVULANATE POTASS.200 MG
- ❖ AMOXYCILLIN 500 GM CLAVULANATE POTASSIUM 100 MG
- ❖ AMPICILLIN 1 GM SULBACTAM 500 MG
- ❖ TAZOBACTAM 250 MG PIPERACILLIN 2 GM
- ❖ TAZOBACTAM 125 MG PIPERACILLIN 1 GM
- ❖ TAZOBACTAM 500 MG PIPERACILLIN 4 GM
- ❖ PROCAINE PENICILLIN
- ❖ BENZATHINE PENICILLIN

## CEPHALOSPORINS GROUPS

- ❖ CEFTRIAXONE 500 MG
- ❖ CEFTRIAXONE 250 MG
- ❖ CEFTRIAXONE 125 MG
- ❖ CEFTRIAXONE 1 GM
- ❖ CEFTRIAXONE 250 MG+ SULBACTAM 125 MG
- ❖ CEFTRIAXONE 500 MG+ SULBACTAM 250 MG
- ❖ CEFTRIAXONE 1 GM+ SULBACTAM 500 MG
- ❖ CEFTRIAXONE 1 GM+ TAZOBACTAM 62.5 MG
- ❖ CEFTRIAXONE 1 GM + TAZOBACTAM 31.5 MG
- ❖ CEFUROXIME 250 MG
- ❖ CEFUROXIME 750 MG
- ❖ CEFUROXIME 1.5 GM



## CEPHALOSPORINS GROUPS

- ❖ CEFEPIME 1 GM
- ❖ CEFEPIME 1000 MG AMIKACIN 500 MG
- ❖ CEFEPIME 1 GM+ TAZOBACTAM 125 MG
- ❖ CEFOTAXIME 250 MG
- ❖ CEFOTAXIME 500 MG
- ❖ CEFOTAXIME 1 GM
- ❖ CEFOTAXIME 250 MG+ SULBACTAM 125 MG
- ❖ CEFOTAXIME 500 MG+ SULBACTAM 250 MG
- ❖ CEFOTAXIME 1 GM+ SULBACTAM 500 MG
- ❖ CEFPIROME SULPHATE 1 GM
- ❖ CEFPIROME 1 GM SULBACTAM 500 MG
- ❖ CEFOPERAZONE 1 GM

## CEPHALOSPORINS GROUPS

- ❖ CEFOPERAZONE 500 MG & SULBACTAM 500 MG
- ❖ CEFOPERAZON 1 GM & TAZOBACTAM 125 MG
- ❖ CEFOPERAZONE 1 GM & SULBACTAM 500 MG
- ❖ CEFTAZIDIME 1 GM
- ❖ CEFTAZIDIME 1 GM & TOBRAMYCIN 120 MG
- ❖ CEFTAZIDIME 1 GM + TAZOBACTAM 125 MG

# CARBAPENEM ANTIBIOTICS

---

- ❖ MEROPENEM 1 GM INJ
- ❖ MEROPENEM 500 MG
- ❖ MEROPENEM 1 GM + SULBACTAM 500 MG
- ❖ MEROPENEM 250 MG
- ❖ MEROPENEM 2 GM
- ❖ MEROPENEM 1 GM + TAZOBACTAM 0.125 MG
- ❖ MEROPENEM 2 GM + SULBACTAM 1 GM
- ❖ DORIPENEM 500 MG
- ❖ IMIPENEM 500 MG + CILASTAIN 500 MG
- ❖ IMIPENEM 1 GM + CILASTAIN 1 GM
- ❖ IMIPENEM 250 MG + CILASTAIN 250 MG
- ❖ COLISTIMETHATE 1 MIU
- ❖ COLISTIMETHATE 2 MIU
- ❖ COLISTIMETHATE 3 MIU

# LYOPHILIZED PRODUCT

- ❖ PANTAPRAZOLE
- ❖ OMEPRPRAZOL
- ❖ AZITHROMYCIN
- ❖ LEUCOVERIN
- ❖ HYDROCORTIZONE
- ❖ COLISSTIMETHANE SODIUM
- ❖ VECURONIUM BROMIDE
- ❖ VINOELBINE
- ❖ CORIONIC GONADOTHPNIN

## Provision for future expansion

- For immediate expansion we have ready space for Beta-lactam laboratory.
- We have open space for Cephalosporin facilities, FFS facilities, Oncology Drugs and any new section etc.